

C:\Local\Revit\566001 Davidoff Cigar Fashion Show\_CENTRAL\_anno.rvt  
7/10/2015 2:52:00 PM

FINISH AND MATERIAL LEGEND			
WALLS			
	TYPE	COLOR	MANUFACTURER
LP-1000	LAMINATE OVER 3/4" THICK PLYWOOD SUBSTRATE	T.B.D.	TREEFROG VENEER
MET-1000	LAMINATE OVER 3/4" THICK PLYWOOD SUBSTRATE	T.B.D.	TREEFROG VENEER
PT-1000	EGG SHELL PAINT	T.B.D.	SHERWIN WILLIAMS
PT-1000	EGG SHELL PAINT	T.B.D.	SHERWIN WILLIAMS
PT-1001	FLAT PAINT	T.B.D.	SHERWIN WILLIAMS
PT-1002	SEMI GLASS PAINT	T.B.D.	SHERWIN WILLIAMS
PT-1003	SEMI GLASS PAINT	T.B.D.	SHERWIN WILLIAMS
WC-1000	WALL COVERING	T.B.D.	COLOUR & DESIGN
CT-1001	12" X 24" X 3/8" PORCELAIN WALL TILE	T.B.D.	AMERICAN OLEAN
CEILINGS			
	TYPE	COLOR	MANUFACTURER
LP-1000	LAMINATE OVER 3/4" THICK PLYWOOD SUBSTRATE	T.B.D.	TREEFROG VENEER
PT-1001	FLAT PAINT	T.B.D.	SHERWIN WILLIAMS
FLOORS			
	TYPE	COLOR	MANUFACTURER
QT-1000	3/8" THICK QUARRY TILE	T.B.D.	T.B.D.
CT-1000	12" X 24" X 3/8" THICK PORCELAIN TILE	T.B.D.	AMERICAN OLEAN
WD-1000	WOOD FLOOR OVER CONCRETE	T.B.D.	T.B.D.
BASE / COUNTER			
	TYPE	COLOR	MANUFACTURER
ST-1000	3/4" MARBLE OVER PLYWOOD SUBSTRATE OR CEMENT BOARD	T.B.D.	DAL TILE

NOTES:  
ALL MATERIALS USED TO MEET APPLICABLE FEDERAL, STATE AND LOCAL FIRE CODE REQUIREMENTS.  
ALL WALL AND CEILING FINISHES TO MEET OR EXCEED REQUIREMENTS OF TABLE 803.9 FOR OCCUPANCY TYPE A-2 FOR FULLY SPRINKLERED BUILDING.

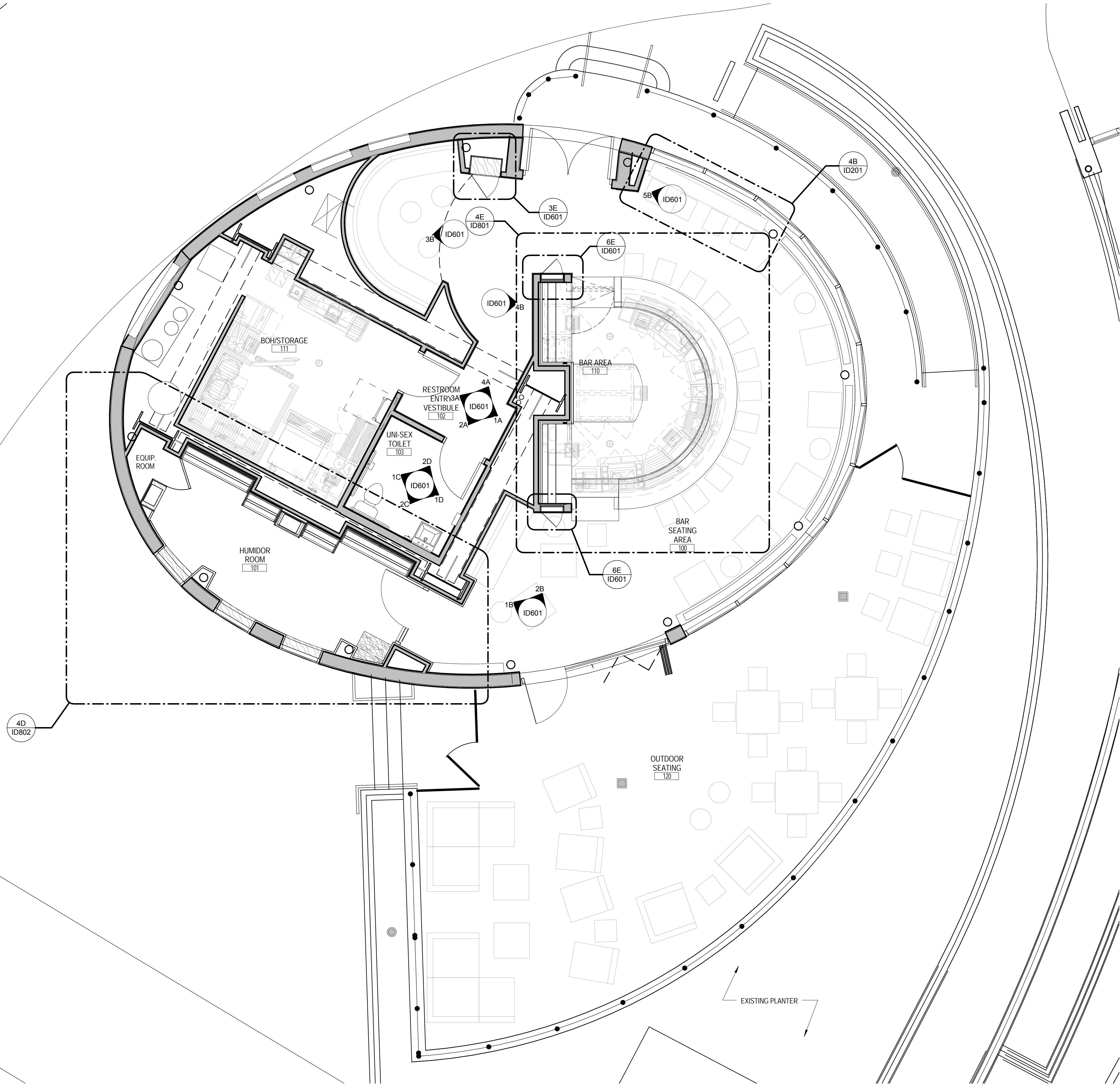

3E LEVEL 1 ANNOTATION PLAN  
1/4" = 1'-0"

Δ	Date	Description
1	07.10.15	BLDG DEPT COMMENT

**FRIEDMUTTER GROUP**  
ARCHITECTURE / INTERIOR DESIGN / FINISHING STUDIOS  
SPECIALIZING IN MULTITUDE PROJECTS  
1000 WEST 10TH AVENUE, SUITE 100, DENVER, CO 80202  
TEL: 303.733.1111 FAX: 303.733.1112  
WWW.FRIEDMUTTERGROUP.COM

STAMP

CONSULTANT

PROJECT NAME  
**DAVIDOFF OF GENEVA CIGAR BAR**  
**- TENANT IMPROVEMENT**  
FASHION SHOW MALL - SOUTH PYLON  
3200 LAS VEGAS BLVD. SOUTH #1245  
LAS VEGAS, NEVADA 89109

KEY PLAN

DRAWN BY  
FRIEDMUTTER GROUP  
CHECKED BY  
FRIEDMUTTER GROUP  
ISSUE DATE  
2015-06-26  
JOB NUMBER  
5566001  
SHEET NAME  
ANNOTATION PLAN  
SHEET NUMBER  
**ID101**